

For quick set-up, follow the steps shown below. Note that malfunction may occur if you do not follow the steps. For further information, please read the instruction manual. Before you start setting up your cash register, prepare three new R6 or LR6 batteries ("AA" size), which are necessary for memory backup, and find a stable and flat place not subjected to direct sunlight.



Important Notice

The cash register will operate correctly only after the following steps have been carried out:



Before You Start

What's in the carton of the Cash Register

- 1 x Cash Register XE-A102
- 1 x Paper Roll
- 2 x Drawer Lock Keys
- 1 x Instruction Manual
- 1 x Quick Start Guide
- 1 x Ink Roller (pre-installed)
- 1 x Take-Up Spool

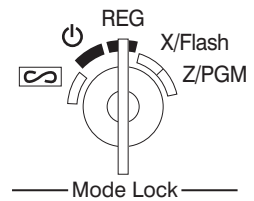

1

Reset The Cash Register

To ensure that your cash register operates properly, initialize it using the following procedure. Find a stable place that is not subject to direct sunlight nor splashing water, and start the initialization.

- Set the Mode Lock to the **REG** position.
- Insert the plug into the AC outlet. A buzzer will sound three times.

IMPORTANT

This operation must be performed without batteries loaded.

- The register display should now show "L 0.00".
- Press **[CL]** to cancel the time display.

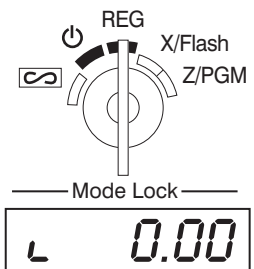

2

Install Batteries

Install three new R6 or LR6 batteries ("AA" size) according to the procedure shown below with the AC cord connected and set the Mode Lock to **REG** position.

- Pull the printer cover forward and detach it.
- Open the battery cover next to the paper roll cradle.
- Install three new R6 or LR6 batteries ("AA" size). Make sure that the batteries are installed as per the diagram below.
- Confirm the no battery symbol "L" light's off.
- Close the battery cover.

1.



3.

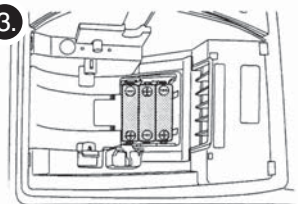

2.

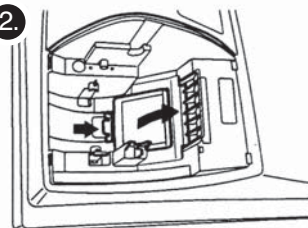

Your Helpline Support Number is 01924 438238

'Select Option 2 for Support' The lines are open 8.30am - 4.30pm Monday-Friday

3

Install the Paper Roll

Receipt

- Push the paper roll release lever in the direction of the arrow and install the paper roll, as shown in the diagram opposite. (Fig. 1).
- Insert the paper straight into the paper inlet, and press . The paper then feeds through and appears in the print area. (Fig. 2).

Journal

- (For journal printing only) Insert the top end of the paper into the slit in the spool shaft and wind the paper two or three turns. (Fig. 3).
- (For journal printing only) Place the take up spool on the bearing. (Fig. 4).
- Replace the printer cover.

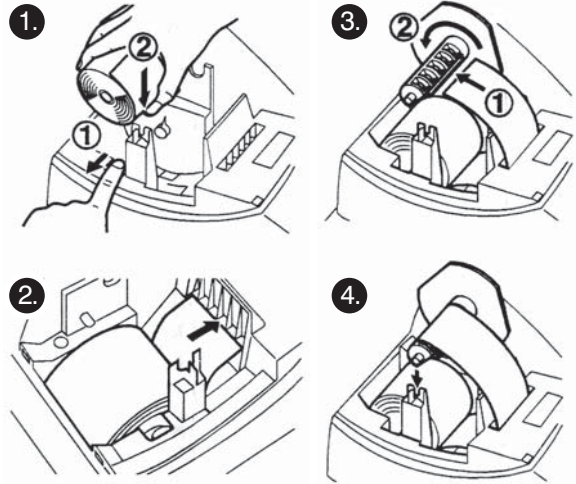

4

Changing The Printing Style

The printer can either issue a customer receipt or provide a journal.

- Set the Mode Lock to the **Z/PGM**.
- Press **2** then .
Enter **0 0 1 0 0 0 0 0** for receipt on print.
0 1 0 0 0 0 0 0 no printing.
1 0 0 0 0 0 0 0 for journal printing.
- Press followed by again to finalise. A programming report will be printed.

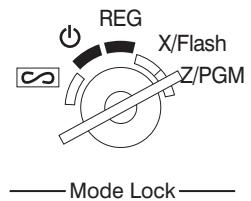

5

Basic Programming

Set the Mode Lock to the **Z/PGM** position

Set Time and Date

- Enter the time in 4 digits ("hhmm" format) using the 24 hour system.
In case of 2:30pm: **1 4 3 0**
- Press once.
- Enter the date in 6 digits using the day-month-year (DD-MM-YY) format.
In case of 15 May 2002: **1 5 0 5 0 2**
- Press twice. A programming report will be printed.

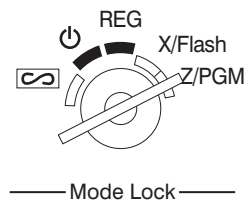

6

Reading and Resetting Sales Data

X Reports (reading)

- Set the Mode Lock to the **X/Flash** position and press .

Z Reports (reading and resetting)

- In the **Z/PGM** mode, press .
- (In this case, grand total resetting is not performed).

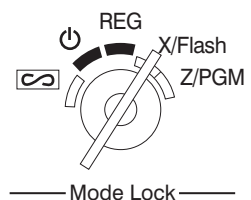

Your Helpline Support Number is 01924 438238

'Select Option 2 for Support' The lines are open 8.30am - 4.30pm Monday-Friday